

THE CITY OF NAPOLEON

BUILDING & ZONING DEPARTMENT

255 W. RIVERVIEW

(419)592-4010

Building Permit

Permit Number: BP2007-137

Page 1 of 1

Printed: 9/4/2007

ADDRESS:

615 Euclid Ave.

Applicant

Name: Lee & Joyce Bolton
Address: 615 Euclid Ave

Approval Date: 9/4/2007
419-592-4594

Owners

Name: Mr. Lee & Joyce Bolton
Address: 615 Euclid Ave
Napoleon, OH 43545

Phone: 419-592-4594

Contractors

Fees and Receipts:

Number	Description	Amount
FEE2007-486	Building Permit Fee (Auto)	\$10.00
Total Fees:		\$10.00
RCPT2007-383		\$10.00
Total Receipts:		\$10.00

privacy fence

APPLICANTS SIGNATURE: _____ DATE: _____

REMINDER: YOU MUST CALL (419)592-4010 FOR AN INSPECTION



CITY OF NAPOLEON GENERAL PERMIT APPLICATION

THIS APPLICATION IS FOR RESIDENTIAL CONSTRUCTION INCLUDING BUILDING, ELECTRICAL, PLUMBING, MECHANICAL, DEMOLITIONS, REMODELING.

DATE: 8-31-07 JOB LOCATION: 615 Euclid Ave Napoleon

OWNER: Lee & Joyce Bolton PHONE: 419-592-4594

OWNER ADDRESS: 615 Euclid Ave CITY: Napoleon ZIP: 43545

CONTRACTOR: US

PHONE #: 419-592-4594 CELL PHONE# _____

CONTRACTOR LICENSED WITH THE CITY OF NAPOLEON?: YES NO:

Is any of the above job going to be subcontracted out? Yes No:

If yes to whom: _____

DESCRIPTION OF WORK TO BE PERFORMED: install Privacy Fence

ESTIMATED COMPLETION DATE: _____

PLEASE MARK THE TYPE OF WORK YOU WILL BE PERFORMING

- | | |
|--|---|
| <input type="checkbox"/> A/C ADD ON 1% | <input type="checkbox"/> REMODELING 1% |
| <input type="checkbox"/> BOILER REPLACEMENT 1% | <input type="checkbox"/> ROOFING 1% |
| <input type="checkbox"/> CURBING | <input type="checkbox"/> SEWER REPAIRS** |
| <input type="checkbox"/> DECKS * 1% | <input type="checkbox"/> SIDEWALK* |
| <input type="checkbox"/> DRIVEWAY* | <input type="checkbox"/> SIDING 1% |
| <input type="checkbox"/> ELECTRICAL SERVICE UPGRADE 1% | <input type="checkbox"/> SHED* (under 200 sq ft) |
| <input type="checkbox"/> ELECTRICAL SERVICE NEW 1% | <input type="checkbox"/> SHED* (over 200 sqft) 1% |
| <input type="checkbox"/> SWIMMING POOL* 1% | <input checked="" type="checkbox"/> FENCE* |
| <input type="checkbox"/> FURNACE REPLACEMENT 1% | <input type="checkbox"/> TEMP ELECTRIC 1% |
| <input type="checkbox"/> ADDITIONS* 1% | <input type="checkbox"/> FURNACE NEW 1% |
| <input type="checkbox"/> WATER TAP (size _____") | <input type="checkbox"/> WINDOWS /DOORS 1% |
| <input type="checkbox"/> LAWN METER 1% | |
| <input type="checkbox"/> PLUMBING 1% | |

1%- EFFECTIVE JUNE 1, 2007 BOARD OF BUILDING STANDARDS FEE

*PLEASE INCLUDE A PICTURE SHOWING MEASUREMENTS FROM EXISTING STRUCTURES AND PROPERTY LINES. INDICATING THE TYPE OF WORK YOU WISH TO PERFORM.

** IF WORK REQUIRES GOING INTO THE STREET A STREET BOND IS REQUIRED!

FOR PERMIT COSTS PLEASE FILL OUT REVERSE SIDE.

PERMIT COST WORKSHEET

<i>JOB</i>	<i>BASE FEE</i>	<i>1% BBS FEE =</i>	<i>PERMIT TOTAL</i>
SIDING (only) TOTAL SQ ____ X 1.00 = ____ +	\$5.00 +	1% =	
ROOFING (only) TOTAL SQ ____ X 1.00 = ____ +	\$5.00 +	1% =	
WINDOWS / DOORS(only) # ____ X 1.00 = ____ +	\$5.00 +	1% =	
ELECTRICAL # OF CIRCUITS ____ X 3.00 = ____ +	\$15.00 +	1% =	
ELECTRICAL SERVICE UPGRADE	\$15.00 +	1% =	
PLUMBING (INSIDE) replacing/ repairs	\$10.00 +	1% =	
SEWER (OUTSIDE)	\$25.00	N/A	
WATER HEATER	\$5.00 +	1% =	
SHED UNDER 200 SQ FT (over 200 see chart)	\$5.00	N/A	
FURNACE OR A/C (REPLACEMNT)	\$5.00 +	1% =	
DEMOLITION (only)	\$30.00	N/A	
SIDEWALK REPLACEMENT/ NEW	\$25.00	N/A	
DRIVEWAY	\$25.00	N/A	

ALL CONSTRUCTION, ALTERATIONS, REMODELING, SHEDS, DECKS, & FENCES NOT LISTED ABOVE IS BASED ON COST OF WORK BEING PERFORMED.

COST OF WORK \$ 848⁰⁰ (SEE CHART) permit fee \$ 10⁰⁰ + 1% = \$ 10⁰⁰

0.00	-	250.00	0.00	11,000.00	-	11,999.00	25.00
250.00	-	999.00	10.00	12,000.00	-	12,999.00	26.00
1,000.00	-	1,999.00	12.00	13,000.00	-	13,999.00	27.00
2,000.00	-	2,999.00	14.00	14,000.00	-	14,999.00	28.00
3,000.00	-	3,999.00	16.00	15,000.00	-	15,999.00	29.00
4,000.00	-	4,999.00	18.00	16,000.00	-	16,999.00	30.00
5,000.00	-	5,999.00	19.00	17,000.00	-	17,999.00	31.00
6,000.00	-	6,999.00	20.00	18,000.00	-	18,999.00	32.00
7,000.00	-	7,999.00	21.00	19,000.00	-	19,999.00	33.00
8,000.00	-	8,999.00	22.00	20,000.00	-	20,999.00	34.00
9,000.00	-	9,999.00	23.00	21,000.00	-	21,999.00	35.00
10,000.00	-	10,999.00	24.00	22,000.00	-	22,999.00	36.00
				Over 22,999		Please Call	

*OTHER FEES NOT LISTED
MAY APPLY

TOTAL PERMIT COSTS \$ _____

THE CITY OF NAPOLEON
BUILDING & ZONING DEPARTMENT
255 W. RIVERVIEW
(419)592-4010



Inspections

Address: 615 Euclid Ave.
Napoleon, OH 43545

Applicant: Lee & Joyce Bolton

Page 1 of 1

Printed: 9/25/2007

Permit Number: BP2007-137

Inspection Date: 9/25/2007

Inspection Number: INSP2007-256

Inspection Type: Building Final

Inspector: Rick Barnes

Status: Complete

Passed?

Required Steps:

Comments:

Other Fields:

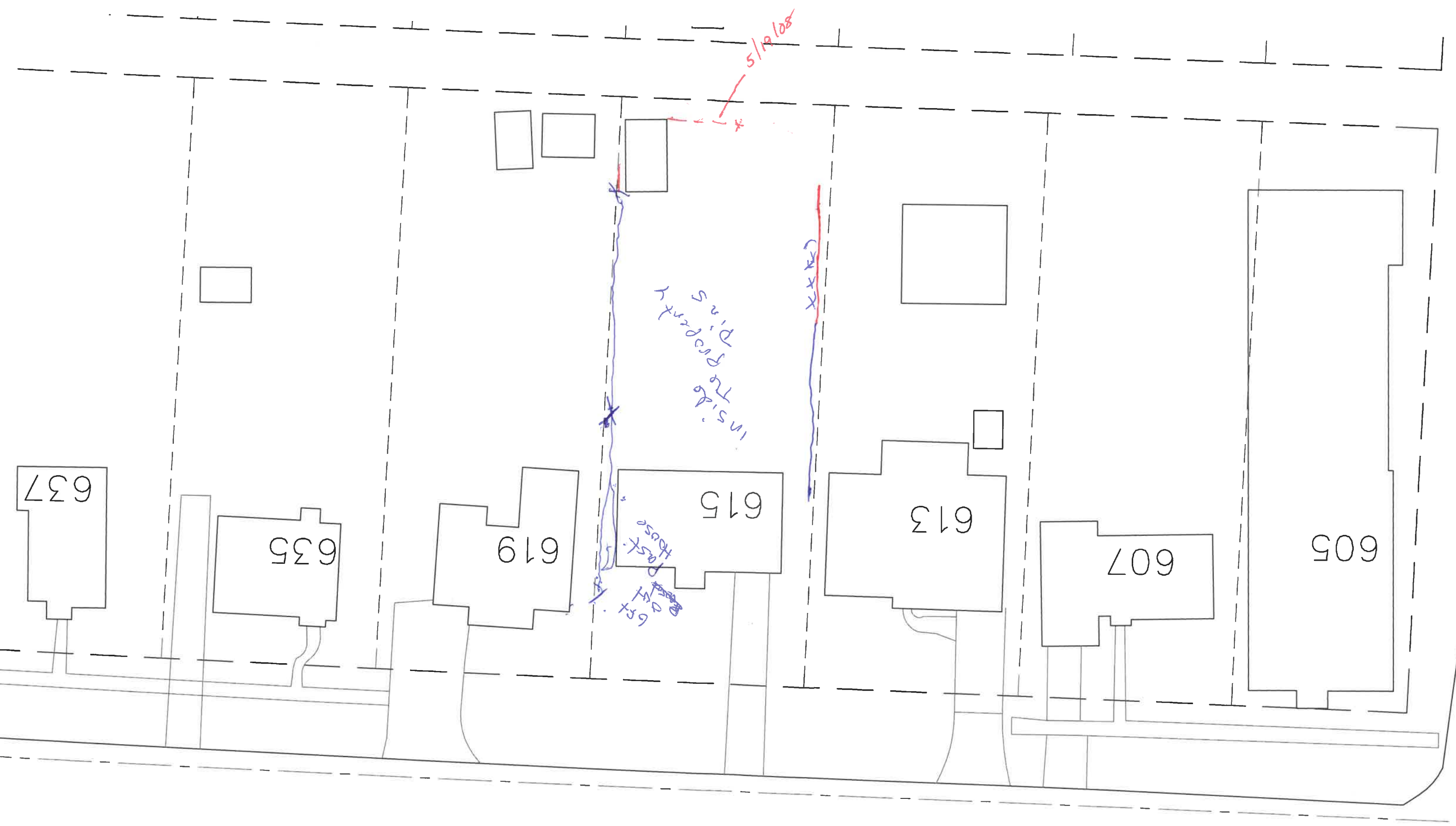

5/19/08

Inside Property Dis

XXXX

Passage to 615

637

635

619

615

613

607

605

